

CERTIFIED RECORD OF LAND CORNER MONUMENTATION

History of original corner establishment:

Corner first established by Herman D. Gradon in 1881 under contract No. 416, Dated Aug. 19, 1881.

Set a basalt stone 16" X 12" X 6", 11" in the the ground, with 5 notches on the South and 3 notches on East edges.

10" diam. Pine, S. 30° E., 66 lks., Mkd. T9SR32ES10BT.

12" diam. Pine, S. 40° W., 42 lks., mkd. T9SR32ES9BT.

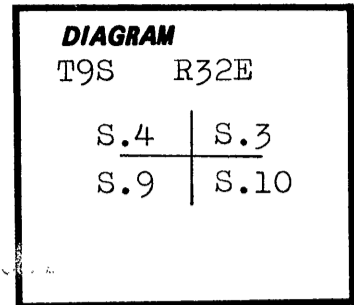

Description of corner evidence found:

Stone, 16" X 8" X 6", (16" X 12" X 6") out of ground and on its side, with 5 notches on one side and 2 notches on another.

28" D.B.H. (10") Ponderosa Pine, S.30° E., 66 lks., with scribes visible on nearly healed face.

44" D.B.H. (12") Ponderosa Pine, S. 40° W., 42 lks., with a healed face.

Description of monument and accessories established to perpetuate the original location of this corner:

Set a 2½" diam. alum. cap in a 2½" X 30" alum. pipe at Corner and buried Cornerstone alongside pipe. Cap mkd. per sketch. Steel posts 3'± N. & E. with attn., mon. & property boundary signs attached.

T9S R32E
S4 | S3
S9 | S10
RPLS 1910
1985

8" D.B.H. Ponderosa Pine, N. 51° E., 2916', scribed T9SR32ES3BT

9" D.B.H. Ponderosa Pine, N. 80° W., 33.9', scribed T9SR32ES4BT.

Each B.T. has a brass washer mkd. RPLS 1910 set btwn.

B & T, B.T. tag, attn. sign and bands and faces painted red.

Declination; 18° 45' East.

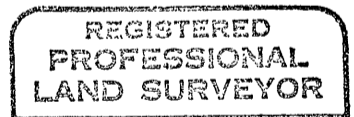

Clayton J. Martin

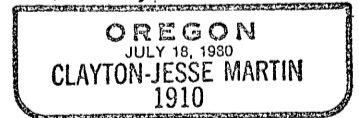

C.J. MARTIN SURVEYING
2751 JUNIPER ST.
SWEET HOME, OR 97386

Office of Juniper County of Grant
State of Oregon, I hereby certify that the within instrument was filed in this office
for record on the 13 day of August, 1985
Robert D. Dwyer by _____
(COUNTY OFFICIAL) (DEPUTY)